

**Read and understand these instructions before installing luminaire.** This luminaire is intended for installation in accordance with the National Electrical Code and local regulations. To assure full compliance with local codes and regulations, check with your local electrical inspector before installation. To prevent electric shock, turn off electricity at main power supply before proceeding. Retain these instructions for maintenance reference.

**Vyv is not responsible for any injuries due to the improper installation or handling of its products.**

**NOTE:** Fixtures must never be lifted from sides or ends, lift fixtures only by cradling in arms until they are supported uniformly by mounting system.

## Installation Instructions

### SURFACE MOUNT:

1. Remove reflector and wire ways, as necessary to expose the mounting holes on the top of the fixture.
2. Install hardware for mounting, using 1/8-32 screws (by others) into the ceiling.
3. Connect power as necessary using K.O.'s on top of the fixture, or thru-wiring K.O.'s at the end of the fixture.
4. Re-install internal bracketry and reflectors.
5. Apply power. Ensure that fixture can be turned on and off and switch between modes

NOTE: Certain fixtures may come with a center mounting holes(s) that may be used in addition to the others.

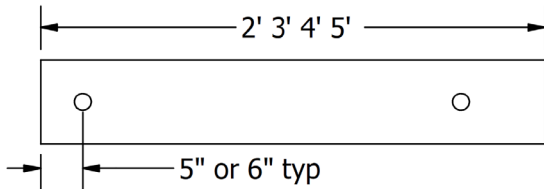

Typical mounting locations. Mounting holes are either 5 or 6 inches from outside edges.

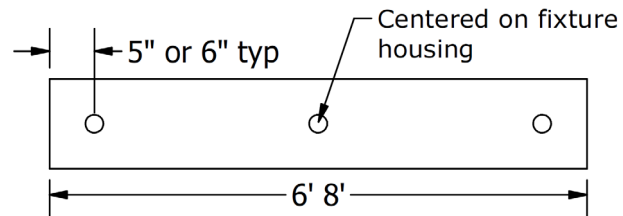

Longer fixtures come with center mounting locations to help support the fixture evenly.

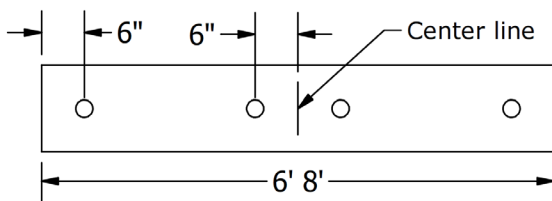

On heavier fixtures there is two center mounting locations spaced evenly off of the center of the fixture.

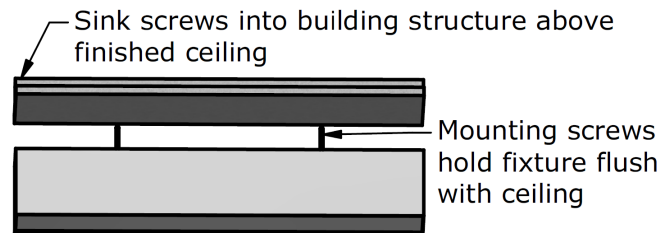

Representative model. Your fixture may look different, but it will mount the same way.

Generic models used, Exact shape may vary with fixture selection. Dimensions and instructions will remain true.